

# MS BEAM Bridge Type Intensive Care Unit



Our company manufactures user-friendly intensive care units, which can be used by your hospitals for years without any problems, in accordance with the standards and keeping human health in the foreground with its knowledge and experience. MedSystem MS BEAM Bridge Type Intensive Care Unit is designed to be used easily and practically by health personnel and has developable features. Cleaning and maintenance is easy.

In line with your hospital's general architectural structure, tailor-made in the direction of your special requests and expectations. MedSystem MS BEAM Bridge Type Intensive Care Unit allows the patient to intervene without any cables or hose obstruction.

The gas and electricity services do not cause cable clutter thanks to the unit coming from the top. Thanks to the shelves mounted on the dry side trolley, you can safely place your medical devices and you will not have any risk of spilling serum or any other liquid on it. You can expand the usage option by mounting serum hangers on the wet side trolley. The gas and electricity services can be positioned on both the front and rear sides, if desired. The rear surface services are designed for general use and the front surface services for emergency use.

MedSystem MS BEAM Bridge Type Intensive Care Unit, in combination with high quality material, fine workmanship, is manufactured in accordance with the requirements of International Standard ISO 13485 Medical and Medical Devices Standard and EN 11197 European Standard. While Patient Units are manufactured, they are subjected to electrical tests according to EN 60601-1 Standard and maximum security is ensured. MedSystem MS BEAM Bridge Type Intensive Care Unit is available in a variety of colors to suit your architectural needs. The units can be painted in any color with the international color code RAL codes.

#### • QUALITY

Thanks to the ISO 9001 and ISO 13485 Quality Systems that MedSystem applies, we aim to provide a better service to our valued customers in every way and we are making product development studies accordingly.

#### • ELECTRICAL SOCKETS

MS BEAM Intensive Care Unit is able to connect all kinds of equipment to electrical outlets. Electrical sockets can be designed and customized according to your usage and requests in different standards, units and shapes. The electrical part of the unit and the gas part are separated completely from each other. Electricity groups are tested according to EN ISO 60601-1 standard.

#### • LIGHTING

MS BEAM Intensive Care Units optionally may have hidden General lighting at the top of the unit (between the support legs). This provides soft lighting support to the healthcare personnel, while providing additional lighting options for the intensive care room. Indirect lighting does not light the patient directly and the patient's eyes will not be dazzled.

#### • GAS OUTLETS

MS BEAM Intensive Care Unit Gas outlets conforming to BS, DIN, and AFNOR standards can be used in line with customer requirements. This option offers a wide range of options with the option of adding different sockets.

#### • ACCESSORIES

MS BEAM Intensive Care Unit uses mobile trolleys and accessories that can be mounted on them. Two separate trolleys can be used as wet and dry sides. The trolley on the dry side also may have aluminum shelves (with or without drawers as option). It has 360° rotation and a break mechanism thus you can position the trolley angle.

There is stainless steel infusion bottle & pump holder poles in Wet side trolley. Plastic vacuum bottle, catheter basket etc. can be fixed on it with proper clamps. Both dry and wet trolleys can move horizontally along the unit by means of the rails under the unit.



CE1984

# MS BEAM BRIDGE TYPE INTENSIVE CARE UNIT

## Characteristics

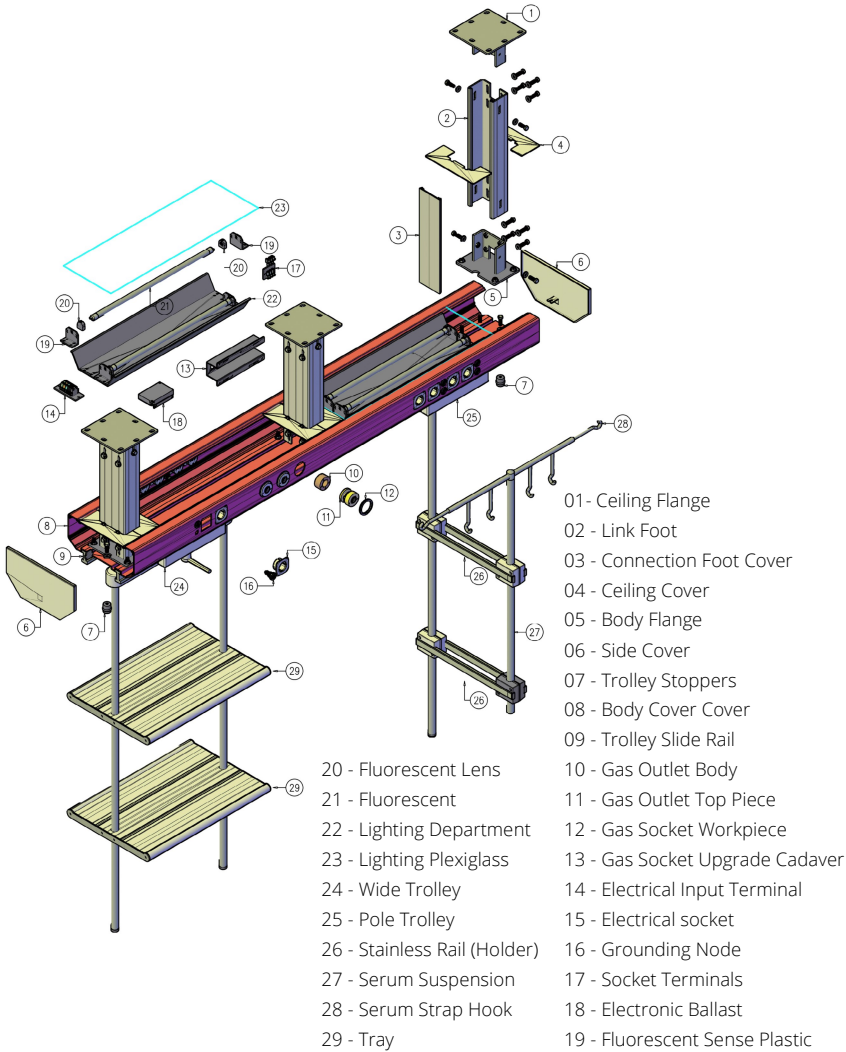

### LIGHTING

Flouresan T5 or LED Lighting (4000 ° K)

2x2 39 T5 Flouresan  
 2x2 24 T5 Flouresan

In the MS BEAM Bridge Intensive Care Unit, a total of 4, 39 T5 or 24 T5 Fluorescent lights are used. Optional LED lighting products can also be included in the unit.

### MEDICAL GAS OUTLETS

According to your requests BS, DIN, AFNOR and other international standards Medical Gas Outlets can be used on the unit. Installation of your gas outlets, which you supply in the direction of your demands, can also be done in the unit.



### ELECTRIC SOCKETS

According to your requests and requests of national or international standarts, various type of electric sockets can be used in MS Bedhead Units. In Europe and Turkey, Type C (CEE 7/16) standard and other international standards such as Type B (Nema 5-15), Type A (Nema 1-15), Type E (CEE 7/4), Type F (CE 7/4), Type G (BS 1363) can also be used. The installation of the electrical outlets that you supply in the direction of your demands can also be fixedto the MS Bedhead Units.



### COMPLIANCE WITH STANDARDS

MedSystem Pendant Units are manufactured according to international quality and safety standards. All Bedhead Units are already in compliance with the new European Safety standard EN ISO 11197. MedSystem products are 'CE' certified under the Medical Device Directive 93/42/EEC. Since the Bedhead Units contain only a gas outlet in the sense of critical material, the CE mark of the gas outlet manufacturer is valid.

### MEDSYSTEM QUALITY CERTIFICATE



Friendly, Flexible and Functional Solutions by MedSystem

MedSystem Medical and Technical Equipment Gas Systems Industry and Trade Limited Company.

Web : www.medsystem.com.tr  
 E-Mail : info@medsystem.com.tr

Serifali Mahallesi, Hattat Sokak  
 PK: 34775 No: 21 Medsystem İş Merkezi  
 Dudullu — Ümraniye  
 İSTANBUL / TÜRKİYE

Phone : +90 216 415 56 60 (pbx)  
 Fax : +90 216 415 32 24

www.medsystem.com.tr

MedSystem reserves the right to make changes without notice in design, specifications and models. The only warranty MedSystem makes is the Express written warranty extended on the sale or rental of its products.

© 2019 MedSystem, ALL RIGHTS RESERVED